

Exploded Axo

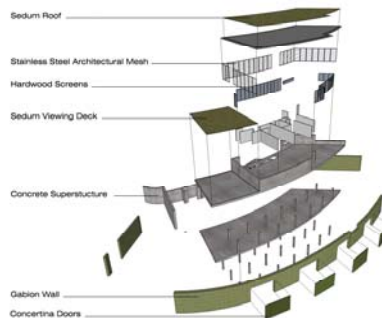

3D Views



The winning scheme

Seapoint Canoe Centre Competition Win

Lee Evans Partnership has just won an invited competition, organised by The Kent Architecture Centre, to design a canoe centre within the valued historic landscape at Sandgate, Hythe. The new premises are for the Seapoint Canoe Centre, an existing water sports facility with a superb track record in instructing, who are seeking Centre of Excellence status from the British Canoe Union.

The brief called for a sturdy, sustainable design which would not only complement its surroundings but create a landmark building. Lee Evans Partnership's concept impressed the judges with its robust simplicity and responsiveness to the challenges posed by the visual constraints of the flat site.

Inspired by its historic military context, the proposed 2-storey building is a cleverly camouflaged structure cut into the bank, at tow path level, which curves gently to follow the sweep of the canal. Gabions at lower level, mesh cages filled with locally quarried Ragstone, echo the stone walls of the old fortifications on the other side of the canal. The gabions and the building's 'brown roof' are both designed to encourage natural fauna growth and create a living building that blends in with its surroundings.

For further details contact:
Lee Evans Partnership, St John's Lane, Canterbury, Kent CT1 2QQ
 Tel: 01227 784 444 Fax: 01227 819 102 Email: architects@lee-evans.co.uk